

CT TAPER SHELL MILL HOLDERS

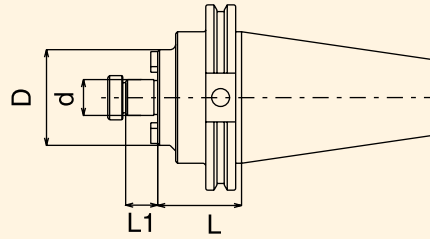

Part Number	Taper	d	L	D	L1	Key Size	Arbor Thread
C4001-0500	CT40	1/2"	1.75"	1.38"	0.57"	1/4"	1/4"-28
C4001-0750	CT40	3/4"	1.75"	2.00"	0.67"	5/16"	3/8"-24
C4011-0750	CT40	3/4"	4.00"	2.00"	0.67"	5/16"	3/8"-24
C4001-1000	CT40	1"	1.75"	2.38"	0.67"	3/8"	1/2"-20
C4011-1000	CT40	1"	4.00"	2.38"	0.67"	3/8"	1/2"-20
C4001-1250	CT40	1-1/4"	2.00"	2.88"	0.67"	1/2"	5/8"-18
C4011-1250	CT40	1-1/4"	4.00"	2.88"	0.67"	1/2"	5/8"-18
C4001-1500	CT40	1-1/2"	2.00"	3.80"	0.93"	5/8"	3/4"-16
C4011-1500	CT40	1-1/2"	4.00"	3.80"	0.93"	5/8"	3/4"-16
C4501-0750	CT45	3/4"	1.75"	2.00"	0.67"	5/16"	3/8"-24
C4501-1000	CT45	1"	1.75"	2.25"	0.67"	3/8"	1/2"-20
C4501-1250	CT45	1-1/4"	1.75"	2.88"	0.67"	1/2"	5/8"-18
C4501-1500	CT45	1-1/2"	2.00"	3.80"	0.93"	5/8"	3/4"-16
C4501-2000	CT45	2"	2.00"	4.38"	0.93"	3/4"	1"-14
C5001-0750	CT50	3/4"	1.75"	2.00"	0.67"	5/16"	3/8"-24
C5011-0750	CT50	3/4"	4.00"	2.00"	0.67"	5/16"	3/8"-24
C5021-0750	CT50	3/4"	6.00"	2.00"	0.67"	5/16"	3/8"-24
C5031-0750	CT50	3/4"	8.00"	2.00"	0.67"	5/16"	3/8"-24
C5001-1000	CT50	1"	1.75"	2.75"	0.69"	3/8"	1/2"-20
C5011-1000	CT50	1"	4.00"	2.75"	0.69"	3/8"	1/2"-20
C5021-1000	CT50	1"	6.00"	2.75"	0.69"	3/8"	1/2"-20
C5031-1000	CT50	1"	8.00"	2.75"	0.69"	3/8"	1/2"-20
C5001-1250	CT50	1-1/4"	1.75"	2.88"	0.69"	1/2"	5/8"-18
C5011-1250	CT50	1-1/4"	4.00"	2.88"	0.69"	1/2"	5/8"-18
C5021-1250	CT50	1-1/4"	6.00"	2.88"	0.69"	1/2"	5/8"-18
C5031-1250	CT50	1-1/4"	8.00"	2.88"	0.69"	1/2"	5/8"-18
C5001-1500	CT50	1-1/2"	2.00"	3.80"	0.93"	5/8"	3/4"-16
C5011-1500	CT50	1-1/2"	4.00"	3.80"	0.93"	5/8"	3/4"-16
C5021-1500	CT50	1-1/2"	6.00"	3.80"	0.93"	5/8"	3/4"-16
C5031-1500	CT50	1-1/2"	8.00"	3.80"	0.93"	5/8"	3/4"-16
C5001-2000	CT50	2"	2.00"	4.38"	0.93"	3/4"	1"-14
C5011-2000	CT50	2"	4.00"	4.38"	0.93"	3/4"	1"-14
C5021-2000	CT50	2"	6.00"	4.38"	0.93"	3/4"	1"-14

HSBALANCE™ Shell Mill Holders

For high speed applications, refer to the HSBALANCE™ section in the Advanced Products Catalog