

## CT50 END MILL HOLDERS (cont.)

Part Number	Taper	d	L	L1	D	Set Screw
C5016-1250	CT50	1-1/4"	6.00"	2.55"	2.48"	3/4-16X11/16 (2)
C5026-1250	CT50	1-1/4"	8.00"	2.55"	2.48"	3/4-16X11/16 (2)
C50S6-1500	CT50	1-1/2"	2.25"	2.83"	2.75"	3/4-16X11/16
C5006-1500	CT50	1-1/2"	4.50"	2.83"	2.99"	3/4-16X11/16 (2)
C5016-1500	CT50	1-1/2"	7.00"	2.83"	2.99"	3/4-16X11/16 (2)
C5026-1500	CT50	1-1/2"	9.00"	2.83"	2.99"	3/4-16X11/16 (2)
C50S6-2000	CT50	2"	3.63"	3.34"	3.74"	1"-14X7/8 (2)
C5006-2000	CT50	2"	5.37"	3.34"	3.74"	1"-14X7/8 (2)
C5016-2000	CT50	2"	8.00"	3.34"	3.74"	1"-14X7/8 (2)
C5026-2000	CT50	2"	10.00"	3.34"	3.74"	1"-14X7/8 (2)
C5006-2500	CT50	2-1/2"	6.00"	3.66"	4.25"	1"-14X7/8 (2)

## CT50 END MILL HOLDERS (METRIC)

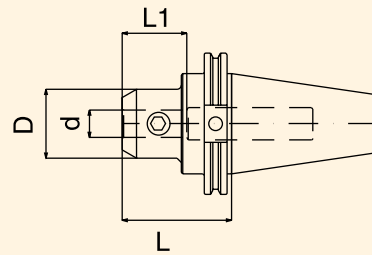

Part Number	Taper	d	L	L1	D	Set Screw
C5006-6	CT50	6mm	2.50"	1.10"	0.79"	1/4-28X1/4
C5006-8	CT50	8mm	2.50"	1.10"	0.87"	5/16-24X1/4
C5006-10	CT50	10mm	2.50"	1.26"	1.00"	3/8-24X5/16
C5006-12	CT50	12mm	2.63"	1.50"	1.38"	7/16-20X3/8
C5006-14	CT50	14mm	3.00"	1.61"	1.65"	9/16-18X1/2
C5006-16	CT50	16mm	3.00"	1.61"	1.65"	9/16-18X1/2
C5006-18	CT50	18mm	3.00"	1.77"	1.89"	5/8-18X1/2
C5006-20	CT50	20mm	3.00"	1.77"	1.89"	5/8-18X1/2
C5006-25	CT50	25mm	4.00"	2.36"	2.36"	3/4-16X11/16 (2)
C5006-32	CT50	32mm	4.00"	2.55"	2.48"	3/4-16X11/16 (2)
C5006-40	CT50	40mm	4.50"	2.95"	3.07"	3/4-16X11/16 (2)
C5006-42	CT50	42mm	4.50"	2.83"	3.07"	3/4-16X11/16 (2)
C5006-50	CT50	50mm	5.37"	3.35"	3.74"	1"-14X7/8 (2)

Note: End Mill Holders come equipped with set screws.

### HSBALANCE™ End Mill Holders

For high speed applications, refer to the HSBALANCE™ section in the Advanced Product Catalog